

Volkswagen New Beetle Service Manual: 1998-2007 including convertible

Price: \$109.95

Bentley Stock Number: VB07

Publication Date: 2007.oct.5

ISBN-10: 0-8376-1542-9

ISBN-13: 978-0-8376-1542-4

Softcover, 8 3/8 in. x 11 in.

Case quantity: 5

1624 pages, 2272 photos, illustrations and diagrams

The Volkswagen New Beetle Service Manual: 1998-2007 is a comprehensive source of service information and specifications for Volkswagen New Beetle models from 1998 to 2007. This manual supersedes our previous 1998-2002 manual with five more model years of coverage, including new repair information for the convertible. If you're looking for better understanding of your 1998 through 2007 Volkswagen New Beetle, look no further than Bentley.

Features:

- Maintenance procedures for everything from routine oil changes to replacing key battery in remote control. This manual tells you what to do and how and when to do it.
- Engine and cylinder head service, repair and reconditioning, including camshaft timing belt replacement.
- Explanation of Motronic 5.9.2, ME7 and Diesel Turbo Direct Injection (TDI) engine management systems.
- Emission control tests, repairs and adjustments, including Exhaust Gas Recirculation (EGR) and Secondary Air Injection (AIR) system.
- Drivetrain maintenance, troubleshooting, adjustment and repair, including hydraulic clutch, gearshift linkage, and drive axles.
- Suspension component replacement, including front struts, rear shocks, rear coil springs, and wheel bearing/hub units.
- Coverage of ABS/EDL/ASR/ESP brake and drivetrain systems.
- Heating and air conditioning repair, including A/C component replacement.
- Body adjustment and repairs, including front and rear clip removal and installation.
- Wiring schematics, fuse/relay locations and a general explanation of electrical circuitry.
- Comprehensive Volkswagen factory tolerances, wear limits, adjustments, and tightening torques that you've come to expect from Bentley manuals.

Bentley repair manuals provide the highest level of clarity and comprehensiveness for service and repair procedures.

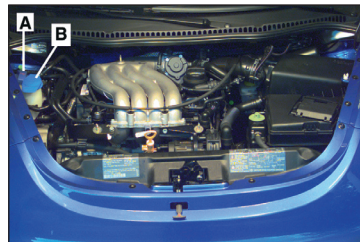

See how to perform routine maintenance procedures, such as checking fluids.
03 Maintenance

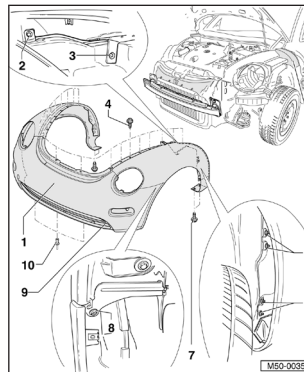

Fully detailed exploded views including front body assembly.
50 Body-Front

Engines covered:

- 1.8L turbo gasoline (engine code: APH, AWV, AWP, BKF, BNU)
- 1.9L TDI diesel (engine code: ALH, BEW)
- 2.0L gasoline (engine code: AEG, AVH, AZG, BDC, BEV, BGD)
- 2.5L gasoline (engine code: BPR, BPS)

Transmissions covered:

- 02J 5-speed manual
- 02M 5- and 6-speed manual
- 0A4 5-speed manual
- 01M 4-speed automatic
- 09G 6-speed automatic
- 02E 6-speed direct shift gearbox (DSG)