



Volkswagen New Beetle Service Manual: 1998-2010 including convertible

Price: \$149.95

Bentley Stock No: VB10

Publication Date: 2010.sept.1

ISBN: 978-0-8376-1640-7

Hardcover, 8 3/8 in. x 11 in.

Case quantity: 1

1664 pages, 2647 photos, illustrations and diagrams

The **Volkswagen New Beetle Repair Manual: 1998-2010** is a comprehensive source of service information and specifications for the New Beetle from 1998 to 2010. Whether you're a professional or a do-it-yourself Volkswagen owner, this manual will help you understand, care for and repair your vehicle.

Features:

- Maintenance procedures for everything from routine oil changes to replacing key battery in remote control. This manual tells you what to do and how and when to do it.
- Engine and cylinder head service, repair and reconditioning, including camshaft timing belt replacement.
- Explanation of Motronic 5.9.2, ME7 and Diesel Turbo Direct Injection (TDI) engine management systems.
- Emission control tests, repairs and adjustments, including Exhaust Gas Recirculation (EGR) and Secondary Air Injection (AIR) system.
- Drivetrain maintenance, troubleshooting, adjustment and repair, including hydraulic clutch, gearshift linkage, and drive axles.
- Suspension component replacement, including front struts, rear shocks, rear coil springs, and wheel bearing/hub units.
- Coverage of ABS/EDL/ASR/ESP brake and drivetrain systems.
- Heating and air conditioning repair, including A/C component replacement

Bentley repair manuals provide the highest level of clarity and comprehensiveness for service and repair procedures. If you're looking an indispensable source concerning operation, maintenance and repair, look no further than Bentley.

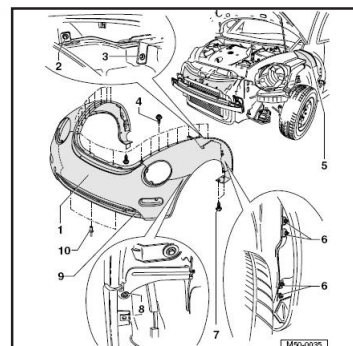

Fully detailed exploded views
including front body assembly.
50 Body-Front



See how to perform routine
maintenance procedures, such
as checking fluids.
03 Maintenance

Models, engines and transmissions covered

Models and engines

- 1.8L turbo gasoline (engine code: APH, AWP, AWP, BKF, BNU)
- 1.9L TDI diesel (engine code: ALH, BEW)
- 2.0L gasoline (engine code: AEG, AVH, AZG, BDC, BEV, BGD)
- 2.5 L gasoline (engine code: BPR, BPS)

Transmissions (remove, install, external service)

- Manual 5-speed 02J
- Manual 5- and 6-speed 02M
- Manual 5-speed 0A4
- Automatic 4-speed 01M
- Automatic 6-speed 09G
- DSG 6-speed 02E